

Energy Revenue Line

The ELEQ quality assurance system is recognized, according to Module D of the conformity assessment procedure, by the National Metrology Institute of German (PTB), so that the ERM current transformer can be used for billing purposes as soon as it is placed on the market. These current transformers are supplied with a declaration of conformity. This enables ELEQ to declare and confirm that its products meet the basic requirements of the law on measurements and calibration.

With Energy Management Systems, the greater need for increased reliability, in terms of accuracy, is fulfilled by means of conformity and the additional metering point (0 VA) of the ERM current transformer. As a result, class accuracy is even maintained when the current is low.

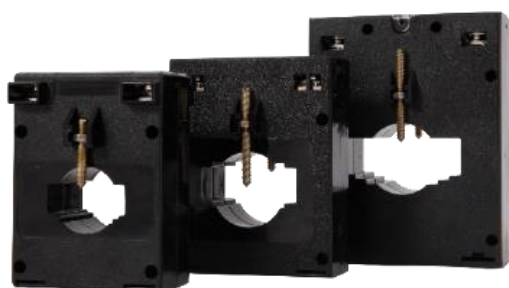

Ordering Specifications

Type	Ratio	Burden Measurement EV*	Class at ext. 120%	Class accuracy at burden	Article Number
ERM60N-E2A	100/5A	1VA	0,5S	0..1 VA	4M2140D
ERM60N-E3A	150/5A	1VA	0,2S	0..1 VA	4M2450D
ERM60N-E3A	200/5A	2VA	0,2S	0..2 VA	4M2451D
ERM60N-E3A	250/5A	2,5VA	0,2S	0..2,5 VA	4M2452D
ERM70N-E4A	300/5A	2,5VA	0,2S	0..2,5 VA	4M3453D
ERM70N-E4A	400/5A	5VA	0,2S	0..5 VA	4M3454D
ERM70N-E4A	500/5A	5VA	0,2S	0..5 VA	4M3455D
ERM70N-E4B	600/5A	5VA	0,2S	0..5 VA	4M3556D
ERM70N-E4B	750/5A	5VA	0,2S	0..5 VA	4M3557D
ERM85-E6A	1000/5A	5VA	0,2S	0..5 VA	4M8758D
ERM60N-E2A	100/1A	1VA	0,5S	0..1 VA	4M2170D
ERM60N-E3A	150/1A	1VA	0,2S	0..1 VA	4M2480D
ERM60N-E3A	200/1A	2VA	0,2S	0..2 VA	4M2481D
ERM60N-E3A	250/1A	2,5VA	0,2S	0..2,5 VA	4M2482D
ERM70N-E4A	300/1A	2,5VA	0,2S	0..2,5 VA	4M3483D
ERM70N-E4A	400/1A	5VA	0,2S	0..5 VA	4M3484D
ERM70N-E4A	500/1A	5VA	0,2S	0..5 VA	4M3485D
ERM70N-E4B	600/1A	5VA	0,2S	0..5 VA	4M3586D
ERM70N-E4B	750/1A	5VA	0,2S	0..5 VA	4M3587D
ERM85-E6A	1000/1A	5VA	0,2S	0..5 VA	4M8788D

* As shown on the rating plate.

Technical Specifications

<i>Environmental conditions</i>	
This product is designed to be safe under the following conditions:	
Location:	Indoor use
Operating temperature:	-5°C .. +40°C
Relative humidity:	5% .. 85%, non condensing
Protection degree:	IP20
<i>Application conditions</i>	
Standard:	IEC EN 61869-2
Rated short-time thermal current:	60 x In / 1s
Continuous thermal current (Icth):	Ext. 120%
Rated insulation level:	0,72/3/-kV
Rated frequency:	50Hz
Instrument Security Factor (FS):	FS5 bei max. Leistung FS10 bei min. Leistung
Class of insulation:	E
Secondary terminals:	Screw terminals
Secondary rated current:	1A oder 5A

Wiring Diagram

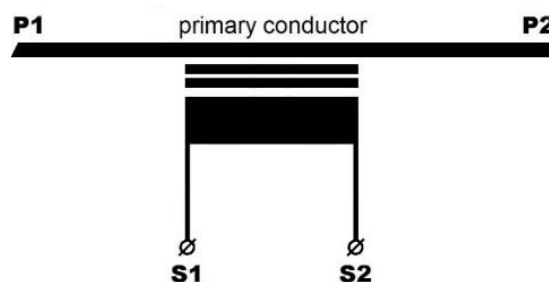

Dimensions

Type; Size	H = Height in mm
ERM60..A, ERM70..A	30
ERM85..A	40
ERM60..B, ERM70..B	50

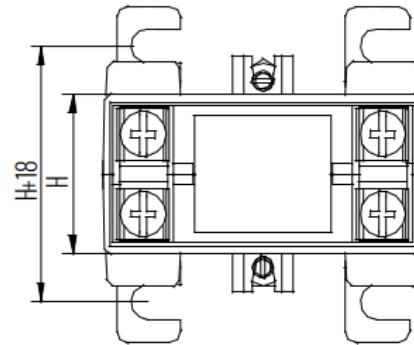

ERM60N-E2

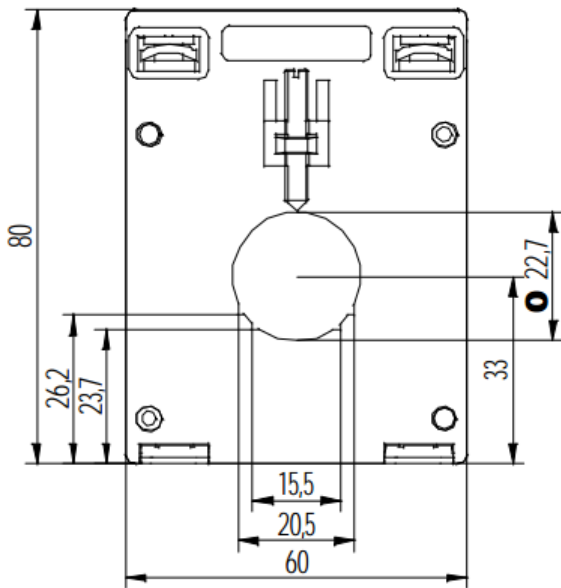

ERM60N-E3

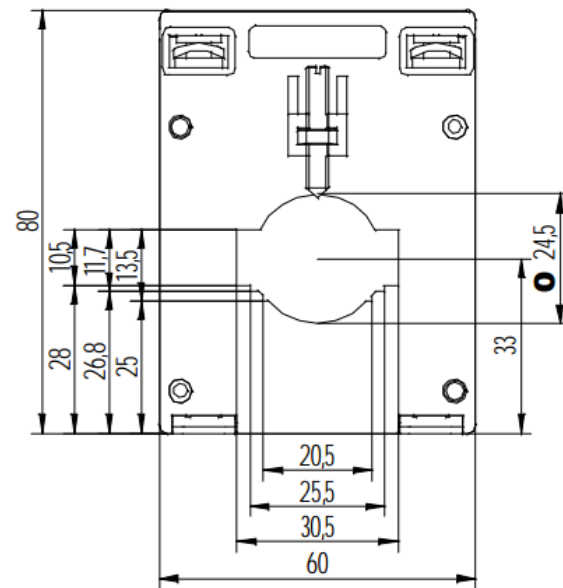

ERM70N-E4

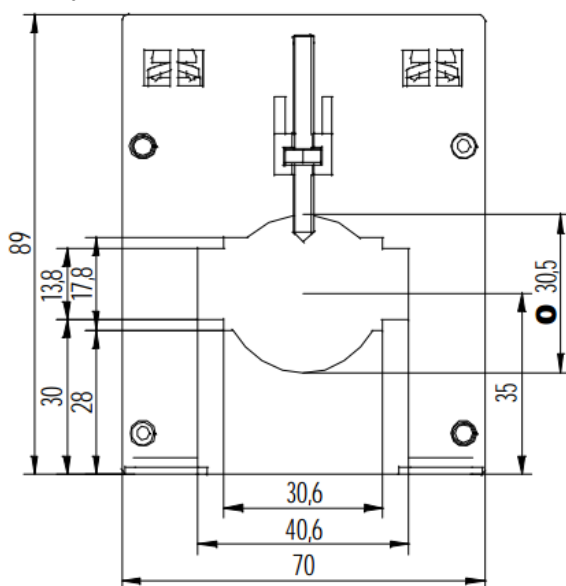

ERM85-E6

