

UGZCAKT..D1 – Double Pole Voltage Transformer

The UGZCAKT D1 is a cast-resin insulated metal-coating indoor double-phase voltage transformer suitable for medium voltage switchgears. The transformer is able to measure voltage up to 12kV and is suitable for top conus. The UGZCAKT D1 is equipped with conical socket connection according to DIN EN 50181. The voltage transformer does not need phase distances, has an increased contact security, is maintenance-free and mountable in any position.

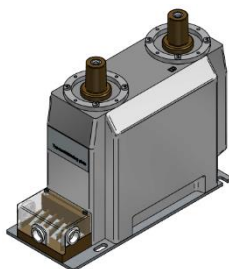

Ordering Specifications

For the customized design of your ELEQ UGZCAKT D1 Voltage Transformer the following information is required:

Mandatory

- Rated primary voltage*
- Rated secondary voltage
- Rated output*
- Accuracy class
- Frequency*

Optional

- Other relevant requirements

*For a specific rated primary voltage with a frequency of 50/60Hz the rated output will be as shown below:

| Rated primary voltage | Rated output at 50/60Hz |
|-----------------------|-------------------------|
| 1,5kV | 600VA |
| 3,0kV | 600VA |
| 6,3kV | 600VA |
| 6,6kV | 600VA |
| 7,2kV | 600VA |
| 10kV | 500VA |
| 11kV | 500VA |

Wiring Diagram IEC 61869-3 e.g.

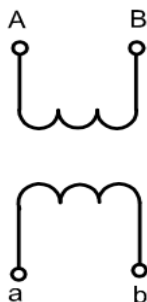

Technical Specifications

| | |
|---|--|
| Environmental conditions | |
| This product is designed to be safe under the following conditions: | |
| Location: | Indoor use |
| Ambient air temperature: | -25°C .. +55°C; other temperatures on request |
| Storage and transport temperature: | -25°C .. +55°C |
| Relative humidity: | 5% .. 95%, non condensing |
| Altitude: | Max. 1000m above NN; at >1000m data required |
| Protection degree (secondary terminal): | IP20 |
| Application conditions | |
| Standard: | IEC 61869-3 / IEEE C57.13; GOST 1983-2001 etc. |
| IEC 61768-3 specification: | |
| Rated thermal limiting output (Sth): | 500VA |
| Rated voltage factor: | 1,2 x Un continuous |
| Rated insulation level: | Max. 12/28/75kV |
| Rated frequency: | 50/60Hz |
| Class of insulation: | E |
| Rated primary voltage: | 1,2 kV - 11kV, other options available on request |
| Rated secondary voltage: | 100V, 110V, 230V; other options available on request |
| Rated output: | As required. |
| Accuracy class: | As required. |
| Secondary terminal: | Screw terminals M5 (max. 2,5Nm) |

Dimensions

