

LS-94 provided with DIN rail
5L6003

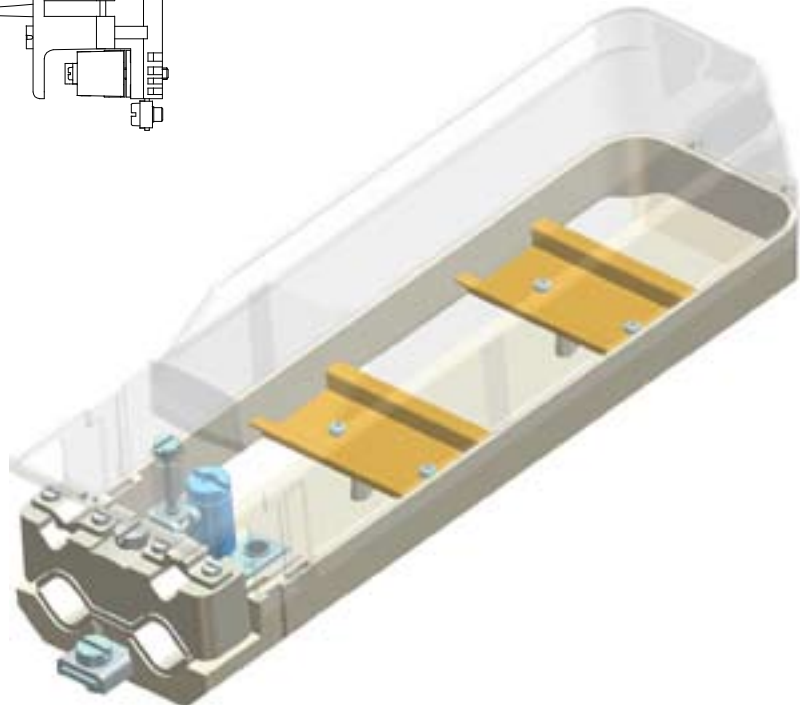
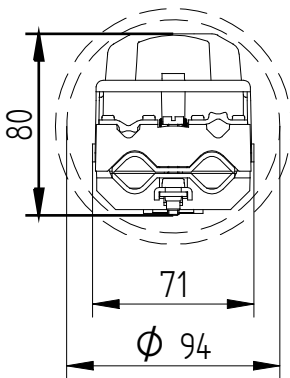
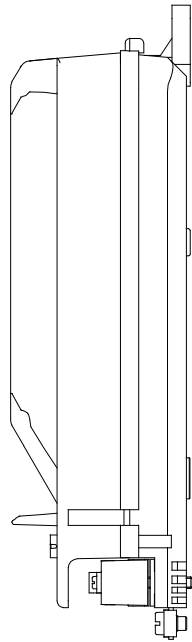
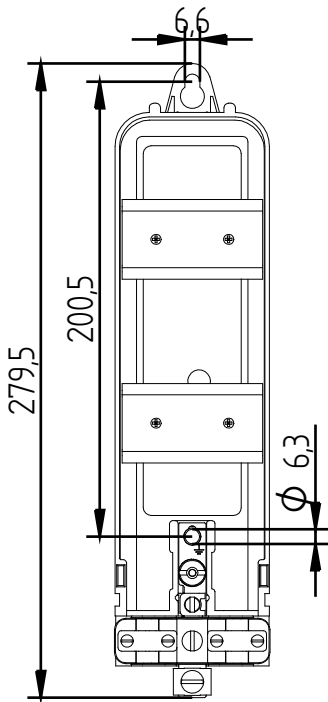
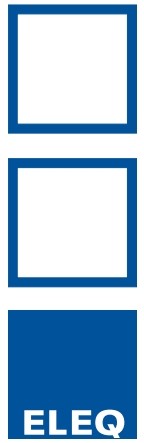

Specifications

Type : LS-94
Article number : 5L6003

Technical specifications

Minimum inside diameter : 94mm
Included with : 2 Pcs dinrail
Pull relief : Yes, max. two ground cables
23mm and 2 lightmast cords

Packing

20 Pcs in a box or 480 Pcs per pallet
Deliverable from stock

ELEQ bv
Tukseweg 130
8331 LH Steenwijk (NL)
T: +31 (0) 521 533 333
F: +31 (0) 521 533 391
www.eleq.com